

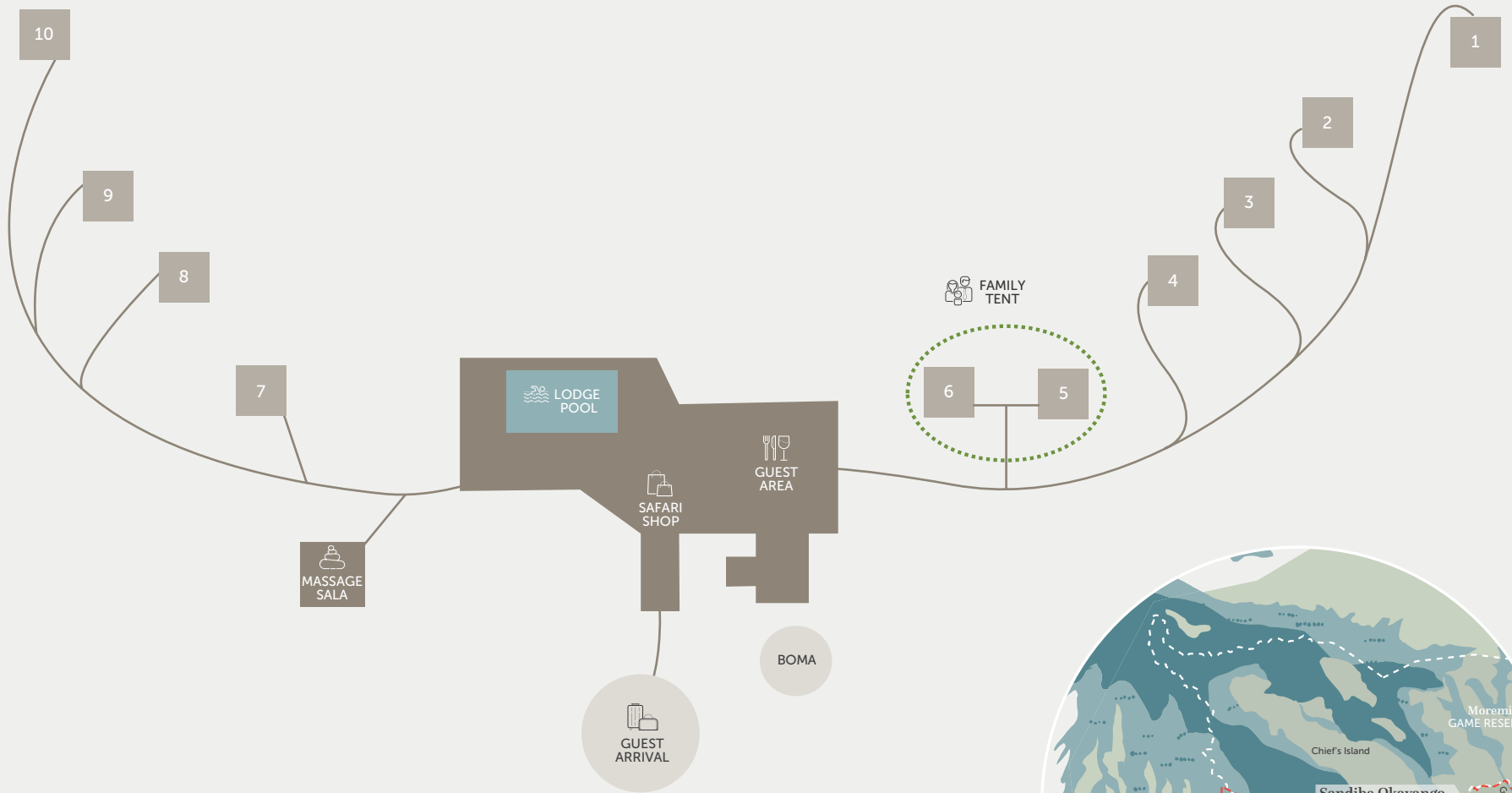

& BEYOND NXABEGA OKAVANGO TENTED CAMP

Nxabega tented suites

DISCOVER THE OKAVANGO DELTA & Beyond Nxabega Okavango Tented Camp



BEYOND Nxabega Okavango Tented Camp

— Road
— Footpaths

DISCOVER THE OKAVANGO DELTA
& Beyond Nxabega Okavango Tented Camp accommodation

Contemporary safari elegance

Blending harmoniously with the environment, nine tented suites (including a family option) are set on raised wooden platforms, cradled under a canopy of towering ebony trees.



INVITING TENTED SUITES



MODERN VANITIES FOR TWO



PRIVATE SALA

DISCOVER THE OKAVANGO DELTA
&Beyond Nxabega Okavango Tented Camp accommodation

TENTED SUITES

9 suites / Maximum 18 guests



RUSTIC ELEGANCE

Each spacious suite features a luxurious bed, an extended private veranda complete with a shaded sitting area, dreamy hanging daybed, and glorious Delta outlooks. The open-designed ensuite bathroom has both an indoor and screened outdoor rainshower, with a flush toilet enclosed by stylish canvas panels.

ROOM FACILITIES

| | |
|----------------------------|---|
| Room sizes (Square meters) | 18 |
| Private veranda | Yes, with private sala |
| Private plunge pool | No |
| Personal bar | Yes |
| Personal coffee station | No |
| Air conditioning / heating | No |
| Overhead fans | Yes |
| Mosquito nets | No (sealed room) |
| Bath | No |
| Shower | Indoor and outdoor shower |
| Seperate W.C | Yes |
| Telephone | Yes |
| Hairdryer | Yes |
| Internet access | Yes |
| In-room safe | Yes |
| Plug type | 220V AC Plug Type C, D, M, N Adapters available |
| Triple bed option | One (children 16 years and younger only) |
| Twin bed option | Yes (however, beds are within the same bedframe) |
| Double bed option | Yes |
| Accessibility | Not suitable for those with mobility issues |

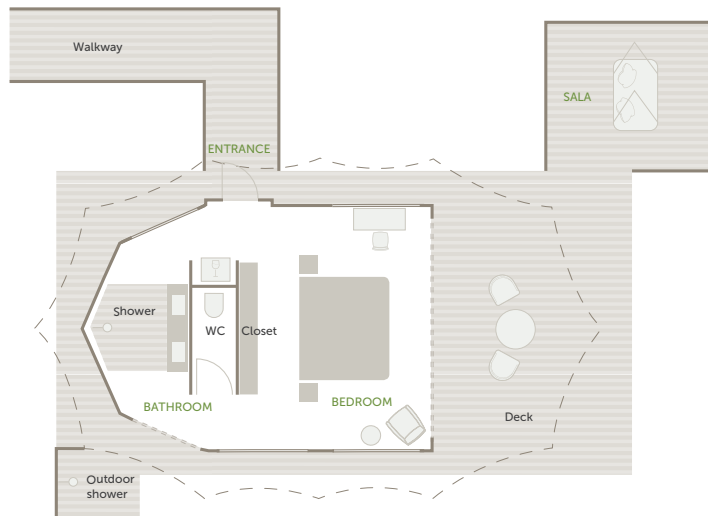

Typical tented suite layout