

FACT SHEET

Location

Widely regarded as Australia's Galapagos and home to abundant native wildlife and spectacular natural beauty, Kangaroo Island sits a mere 15km from the shores of mainland South Australia. As Australia's third largest, the Island is 155km long by 55km wide and covers some 4,500 sq km.

With 21 National and Conservation parks, Kangaroo Island has established itself as a premiere destination for nature lovers of all types. The Island's prolific wildlife includes kangaroos, koalas, seals and sea lions, echidnas and a variety of birdlife, all revelling in this "zoo without fences".

Climate

A destination for all seasons, Kangaroo Island's climate is as dynamic as the scenery – from season to season the Island yields fresh perspectives. The Mediterranean climate produces warm summers and temperate winters. Daytime temperatures range from 25-35°C in summer to 14-18°C in winter.

Accommodation

Twenty-one contemporary suites cantilever along the curve of the limestone cliffs, each with unbroken views of the Southern Ocean and dramatic coastal wilderness. Custom designed furniture, island-inspired textiles and soft furnishings offer luxurious lounging, while Kangaroo Island artists' works offer an inspiration. Watch the sun rise from the comfort of a well dressed king bed, bathe with a view and step into the landscape from the private outdoor terrace.

All suites feature lavish king beds, sunken lounge, dramatic glass-surround bathroom and outdoor terrace with occasional seating and daybed. Other features include walk-in robe, complimentary room bar, optional climate control, heated floors, wireless internet (limited bandwidth), music system, premium amenities, safe and telephone. Bathrobes, slippers, hairdryer and backpacks are provided along with twice-daily housekeeping and signature evening turndown service.

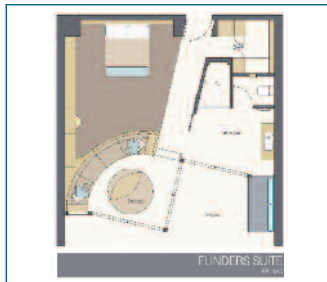

Flinders Suite (11) 65m²

Features spacious interiors, king or twin beds, curved sunken lounge and outdoor terrace with day bed to take advantage of dramatic coastal views.

Capacity: 2 adults in existing bedding / max capacity 2 persons



Remarkable Suite (2) 120m²

Features a king bedroom, separate lounge area with open fire, premium entertainment system, LCD TV and DVD player, spacious ensuite with handmade

timber bath tub and expansive outdoor terrace with day lounge and spa bath.

Capacity: 2 adults in existing bedding / max capacity 3 persons with rollaway



Ocean Retreat (5) 75m²

Generously spacious, Ocean Retreats offer king bedding, lounge with feature fireplace, ensuite with freestanding tub and terrace with day bed.

Capacity: 2 adults in existing bedding / max capacity 3 persons with rollaway

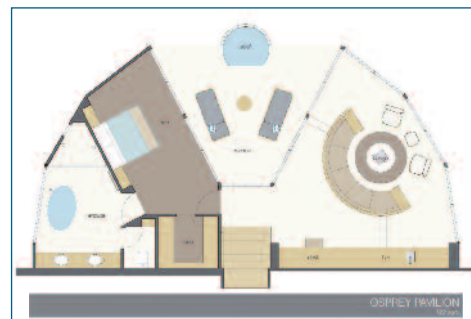

Osprey Pavilion (1) in excess of 120m²

The premium Osprey Pavilion is truly special, with soul-stirring ocean, beach and wilderness views. A unique curved floor plan features

a sunken lounge with open fire and state-of-the-art audio visual system, laptop computer, separate king bedroom, bathroom with hand-sculpted bath and spacious outdoor terrace with daybeds and private plunge spa.

Capacity: 2 adults in existing bedding / max capacity 3 persons with rollaway



Ocean Premium (2) 120m²

Ocean Premium suites feature an additional bedroom and bathroom and offer a separate living area with LCD TV and DVD player. Perfect for

friends and couples travelling together and families.

Capacity: 4 adults OR 2 adults + 2 children in existing bedding / max capacity 5 persons with rollaway.

Check in/out Times

Check in 2pm / Check out 10.30am

Restaurant & Bar

A spectacular sweeping panorama of Hanson Bay provides a dramatic backdrop for savouring contemporary Australian cuisine, showcasing the freshest island and local seasonal produce. A convivial open bar and walk-in cellar highlight premium South Australian wines and beers whilst elegant interiors and personal service ensure a memorable dining experience. *Rates include full gourmet breakfast, light lunch, 4-course dinner with inspired daily menu and all beverages (cellarmasters list additional).*

The Great Room

The design pinnacle of the Lodge, the Great Room features floor to ceiling glass windows with full frontal panoramas and a sumptuous array of lounge choices. Outdoor seating areas and a heated wet-edge plunge pool invite total immersion in the pristine surroundings.

Baudin Lounge

A serene and private place to escape, read a book, watch a movie, enjoy a nature presentation or challenge a friend to a board game! Featuring a comprehensive reference library, interpretive display, movie and game library, the lounge can also be used for intimate meetings and events.

Capacity: 20 boardroom / 40 theatre style

Experiences & Adventures

Southern Ocean Lodge offers guests a complete Kangaroo Island experience. With selected guided island experiences included in the tariff, all guests enjoy a personalised experiential touring itinerary of the Island's unique natural attractions. A range of signature activities are offered daily allowing guests to encounter rich and varied wildlife, indulge in world-class food and wine and discover the Island's unique natural attractions, often with exclusive access and always with a touch of luxe. *Rates include Signature Lodge Experiences.* A menu of Bespoke Experiences provides further opportunity for exploration and excellent private charters are also available at additional cost.

Southern Spa

Housed in its own stunning pavilion, the Southern Spa is an intimate and private oasis of calm set amongst coastal drama. A signature spa menu offers a range of Li'tya rejuvenation and relaxation treatments, inspired by the Aboriginal dreamtime. Three treatment rooms, a steam room and chill lounge offer the ultimate pampering experience.

Services

Reception and boutique, business lounge, wireless internet (limited bandwidth), DVD, CD and reference library, daily laundry service (no dry cleaning) and postal service. Mobile/cell reception is limited on Kangaroo Island. All major credit cards are accepted at the Lodge.

Access

Located at Hanson Bay on the Island's south-west coast, the Lodge is a 50 or 90 minute drive from the airport or ferry terminal respectively. [Air Regional Express](#) (Rex) provide regular daily flights (30 mins) from Adelaide (ADL) to Kangaroo Island – Kingscote (KGC). A 15kg luggage limit per person applies; any excess may be uplifted or stored at Adelaide Airport for a nominal fee. For those guests travelling between Southern Ocean Lodge and sister property [Longitude 131°](#) in the Northern Territory, Qantas operate an excellent daily service from Ayers Rock (AYQ) via Alice Springs (ASP) to Adelaide (ADL) with air connections to Kingscote (KGC) Kangaroo Island via [Regional Express](#). To maximise your experience of each destination and for seamless air connections, a stay at Longitude 131° is recommended prior to Southern Ocean Lodge. [Charter Flights](#) Private charter flights are available from Adelaide to Kingscote or Snug Cove an exclusive private airfield just 30 minutes drive from the lodge. [Ferry SeaLink](#) operate regular 45 minute ferry transfers between Cape Jervis on the mainland and Penneshaw on Kangaroo Island. Cape Jervis is a picturesque two hour drive from Adelaide. [Car Hire](#) Whilst island experiences are included in the tariff, hiring a car can be fun and allows guests to explore Kangaroo Island as they like. Many mainland car hire companies have restrictions regarding their vehicles being driven on Kangaroo Island, and/or boarding the ferry. It's best to check terms with the operator. A good option is to hire a car on the island; [Budget](#) and [Hertz](#) operate both at Kingscote Airport and from the ferry terminal at Penneshaw. For more detailed information view the [Getting There & Away fact sheet](#).

Transfers

The Lodge operates transfers with fellow guests connecting with scheduled flights included in the tariff. Private transfers are available at additional cost and are required for connections with charter flights. Pre or post private touring is also an excellent transfer option.

Children

Southern Ocean Lodge welcomes children ten years and over.

What to Bring

Dress is smart casual at Southern Ocean Lodge and feeling relaxed is key. No matter when the stay, bring comfortable walking shoes, a warm top and a rain jacket. In the cooler months, it's best to pack clothing that can be layered for versatility. Hat, camera, sunscreen and a keen sense of adventure are a must!

Luxury Lodges of Australia

Southern Ocean Lodge is honoured as a founding member of [Luxury Lodges of Australia](#), celebrating a new era of Australian experiential luxury accommodation and adventure.

Lodge Contacts

Southern Ocean Lodge

Hanson Bay, Kangaroo Island SA 5223

T 61 8 8559 7347

F 61 8 8559 7350

E reception@southernoceanlodge.com.au